

PRESCRIBERS

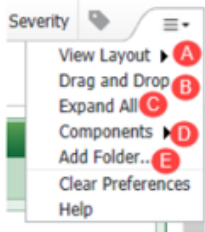

Customize Quick Order Tab

The Quick Order tab has a more options for customization.

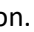

LEGEND	
A	View Layout: Sets the number of columns
B	Drag and Drop: Reorder the components on the page
C	Expand/Collapse All: Expands or Collapses the Folders
D	Components: Select which components are visible
E	Add Folder: Adds a custom folder to the Workflow Tabs

To Reorder the Components on the Workflow Tab:

1. Click on the  icon.
2. Click on **Drag and Drop**. If there is a  this functionality is active.
3. Select the Component title to you wish to move. In this case New Order Entry. Ensure that the  cursor is visible.

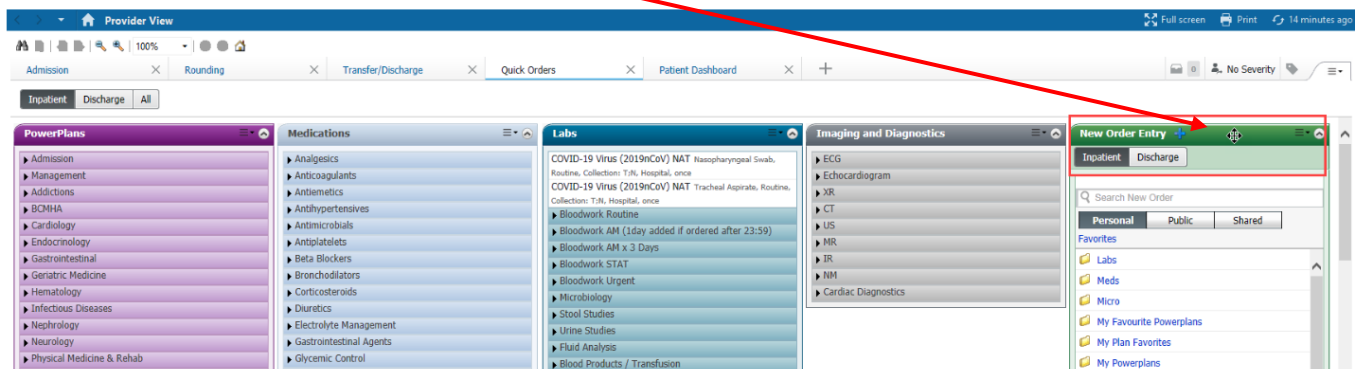
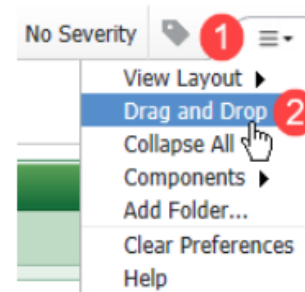

4. Drag and Drop the component to where you want it.

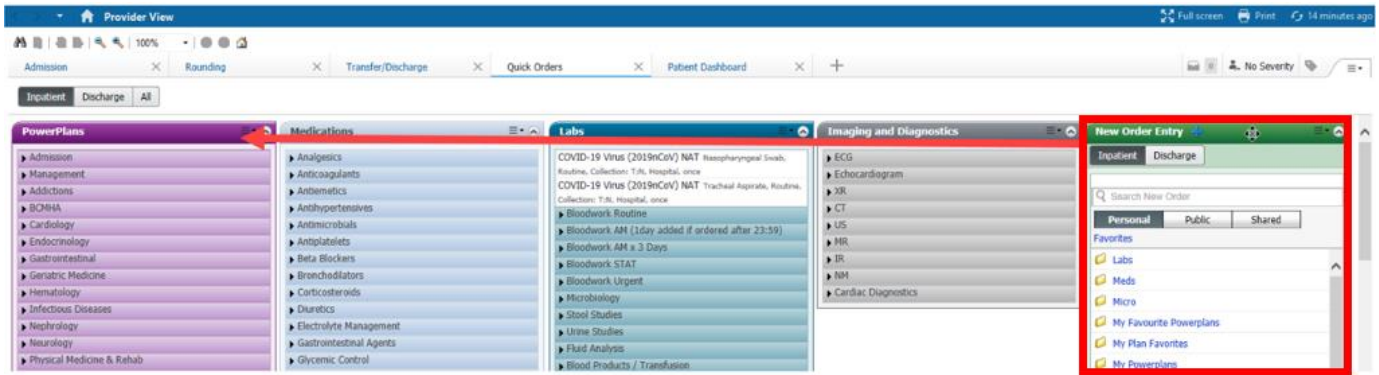

The Component is in the new position.

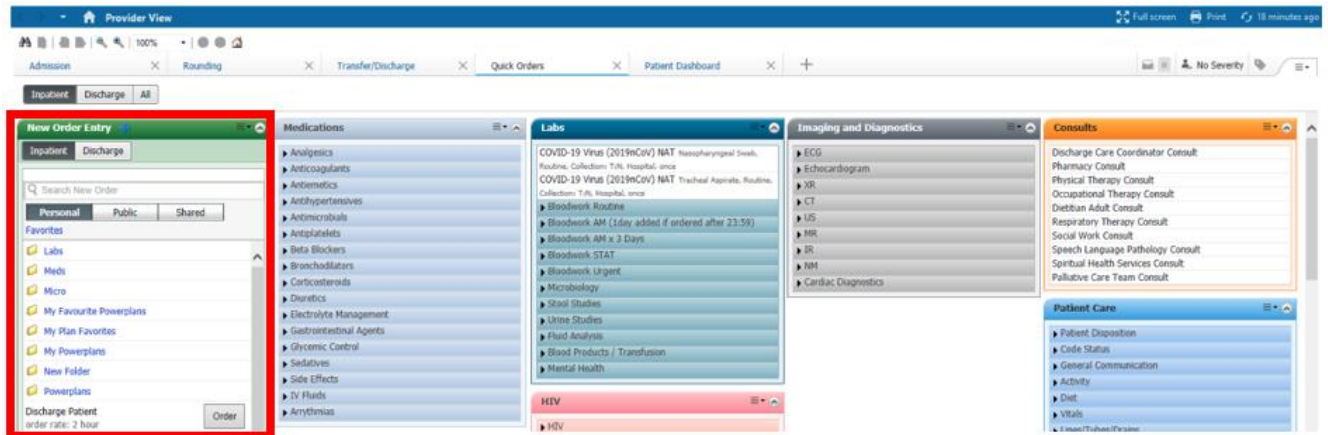

5. When finished click of the **Drag and Drop** functionality.

To Change the Colour of the Component Headers:

1. Click on the **Options**.
2. Click on **Color Theme**.
3. Chose the new colour.

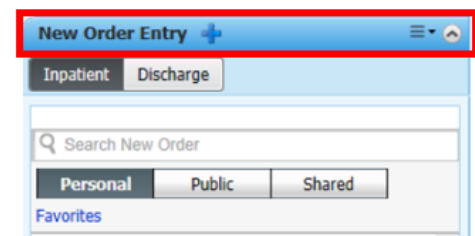
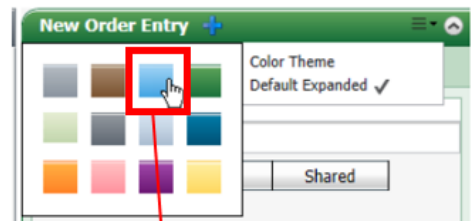
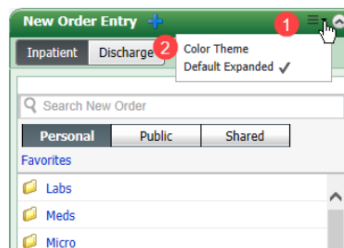

The Component is now in the new colour.